

FSFA100-18-XX-S

Fixed Attenuator, DC-18GHz, 100W, SMA

Electrical Specifications					
1	Nominal Impedance	50 Ω			
2	Average Power ¹	100W @ 25°C			
3	Frequency Range	DC-4GHz	DC-8GHz	DC-12.4GHz	DC-18GHz
4	VSWR	≤1.20	≤1.25	≤1.35	≤1.45
Environmental Specifications					
1	Operating Temperature	-55°C~+125°C			
Mechanical Specifications					
1	Connectors	SMA(m) to SMA(f)-Standard, Polarity Customizable			
2	Body Material	Connector: Brass Heat Sink: Black Anodized Aluminum			
Attenuation, Accuracy & Dimension					
Attenuation (dB)	Accuracy(dB)				Dimension (mm/in)
	DC-4GHz	DC-8GHz	DC-12.4GHz	DC-18GHz	
6~10	±0.7	±0.8	±1.2	±1.5	Φ64*121 [Φ2.52*6.34]
20	±0.7	±0.8	±0.9	±1.5	
30	±0.8	±0.9	±1.0	±1.3	
40	±0.8	±0.9	±1.0	±1.3	
50~70	±0.9~1.0	±1.0	±1.1	±1.4	

Note 1: Power derates linearly to 0.5W at +125°C. Refer to the power derating curve for details.

Outline Drawing (Units: mm/[inch], Tolerance: $\pm 2\%$)

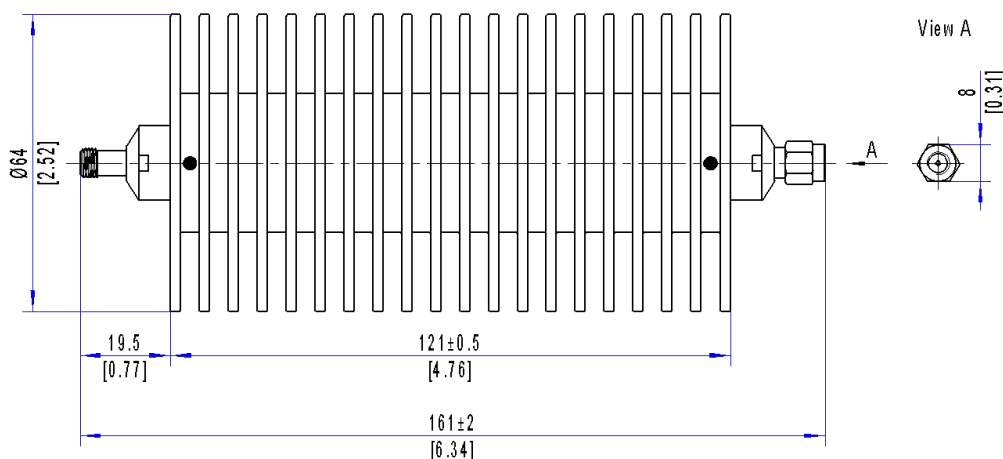

Ordering Information:

Model: **FSFA100-XX-YY-S**

XX = Frequency Range (4GHz, 8GHz, 12.4GHz, 18GHz)

YY = Attenuation Value in dB

Example: 8GHz, 10 dB→**FSFA100-8-10-S**