

FSCT1-110-W

Coaxial Termination, DC~110GHz, 1W, 1.0mm

Electrical Specifications		
1	Nominal Impedance	50 Ω
2	Average Power ¹	1W @ 25°C
3	Peak Power	5W (5 μ s pulse width, 0.5% duty cycle)
4	Frequency Range	DC~110GHz
5	VSWR	≤ 1.50
Environmental Specifications		
1	Operating Temperature	-55°C~+125°C
Mechanical Specifications		
1	Connectors	1.0mm(f)/1.0mm(m)
2	Dimensions	$\Phi 7.5 \times 13.7$ mm [$\Phi 0.30 \times 0.54$ in]
3	Weight	3g

Note 1: Refer to the power derating curve for details.

Outline Drawing (Units: mm/[inch], Tolerance: $\pm 2\%$)

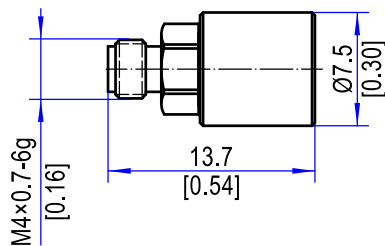

Outline A

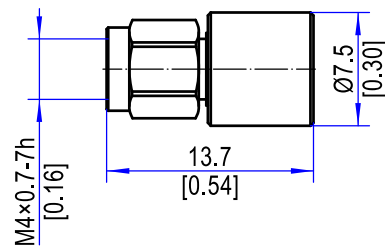

Outline B

Ordering Information:

Model	Connector Type	Outline Drawing
FSCT1-110-W	1.0mm-Female(default)	Outline A
FSCT1-110-WM	1.0mm-Male	Outline B