

## FSCA100-XX-XX-XX-N

Continuously Variable Attenuator, 9~11GHz, 100W

Electrical Specifications		
Impedance	50 Ω	
Average Power	100 W	
Frequency Range	9~11 GHz	
Attenuation Range	0~10 dB (0~20dB/0~30dB options available for single frequency)	
Bandwidth	100 MHz	200 MHz
Attenuation Accuracy	±0.5	±0.75
Insertion Loss	≤1.5 dB	
VSWR	≤1.60:1	
Environmental Specifications		
Operating Temperature	-40°C~+65°C	
Mechanical Specifications		
Connectors	N-Female	
Body Material	Outer Conductor: Nickel Plated Brass Inner Conductor: Gold Plated Beryllium Copper Housing: Aluminum (Black)	
Dimension	Outline: 189*102*75mm	
Weight	Approx. 2 kg	

### Outline Drawing (Units: mm/[inch], Tolerance: $\pm 2\%$ )

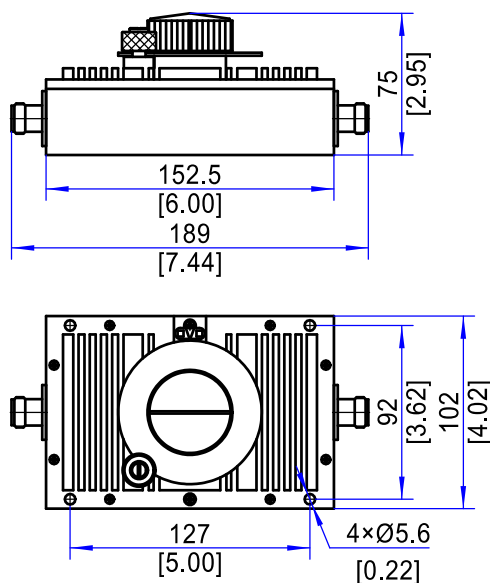

### Ordering Information:

Model: **FSCA100-XX-YY-ZZ-N**

XX = Start Frequency in GHz

YY = Stop Frequency in GHz

ZZ = Attenuation in dB (e.g. 0-10dB→10)

Example: 9-9.1GHz, 0-10dB, N-Female→**FSCA100-9-9.1-10-N**