

FSCA10-0.5-4-20-N

Continuously Variable Attenuator, 0.5~4GHz, 20dB, 10W

Electrical Specifications	
Impedance	50Ω
Average Power	10W
Frequency Range	0.5~4GHz
Attenuation Range	0~20dB
Insertion Loss	≤0.5dB
VSWR	≤1.50:1
Environmental Specifications	
Operating Temperature	-40°C~+65°C
Mechanical Specifications	
Connectors	N-Female
Body Material	Outer Conductor: Nickel Plated Brass Inner Conductor: Gold Plated Beryllium Copper Housing: Aluminum (Blue)
Dimension	186*170*19mm
Weight	Approx. 590g

Outline Drawing (Units: mm/[inch], Tolerance: ± 2%)

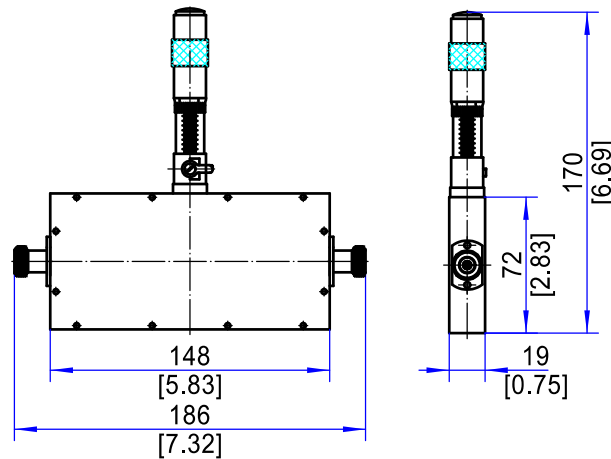

Ordering Information:

Model: **FSCA10-0.5-4-20-N**